

**NAPEX
PHILELIC EXHIBIT**

**TWIN BRIDGES
MARRIOTT HOTEL**
Washington, D.C.
JULY 2-4, 1982

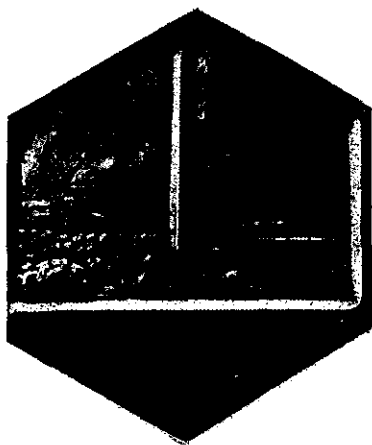

NAPEX Cachet Envelopes (set of three)	75¢
NAPEX Serviced Cachet Envelopes, Station Cancel, 3 days, available on Sunday. Three for	\$1.50
Plate Printers NAPEX Souvenir Card	\$2.00
Awards Banquet Tickets, per person	\$16.00



NAPEX items may be bought and/or ordered
at Board Room, located in the Convention Center Lobby.

HE
6191
N108
1982
NPM

NAPEX — 82

2 - 4 July 1982

PARTICIPATING SOCIETIES

(Society lounges located in Convention Center Lobby)

- Meeting —
AMERICANA UNIT, ATA
- Meeting —
ASSOCIATED STAMP CLUBS of the CHESAPEAKE AREA
- Regional Meeting —
AFDCS, ROBERT C. GRAEBNER CHAPTER
- Meeting —
BUREAU ISSUES ASSOCIATION
- Meeting —
CHINA STAMP SOCIETY
- Meeting —
GEORGE WASHINGTON MASONIC STAMP CLUB
- Meeting —
INTERNATIONAL SOCIETY for JAPANESE PHILATELY
- Meeting —
KOREA STAMP SOCIETY
- Meeting —
LIONS INTERNATIONAL STAMP CLUB
- Luncheon Meeting —
SCANDINAVIAN COLLECTORS CLUB
- Meeting —
S.P.A.
- Meeting —
TURKEY and OTTOMAN PHILATELIC SOCIETY
- Meeting —
WASHINGTON PHILATELIC SOCIETY



**NATIONAL PHILATELIC EXHIBITIONS
OF WASHINGTON, D. C., INC.**

NAPEX OFFICERS

JOHN N. HOFFMAN President
MILTON MITCHELL Vice President
GERHARD S. WOLFF Treasurer
GORDON H. TORREY Secretary
GEORGE S. MANSFIELD Director
CLARENCE A. STILLIONS Director
RALPH I. SIGLER Director
STEPHEN R. TRIPP Director
JOHN W. KAUFMANN Director

MEMBER CLUBS

American First Day Cover Society – R. C. Graebner Chapt. 17
American Society of Polar Philatelists – Iceberg Chapter 3
American Topical Association – Potomac Chapter
Arlington County Recreational Stamp Club
Baltimore Philatelic Society
Capital Precancel Club
China Stamp Society – National Capital Junk Chapter
Collectors Club of Baltimore
Collectors Club of Washington
Dolley Madison Stamp Club
George Washington Masonic Stamp Club
International Society for Japanese Philately
Korea Stamp Society – D.C. Area Chapter
Library of Congress Philatelic Club
Northern Virginia Stamp Club
Rockville-Gaithersburg Stamp Club
Scandinavian Collectors Club – Ntl. Capital Area Chapter 12
Silver Spring Philatelic Society
Society of Indo-China Philatelists
Springfield Stamp Club
U.S.C.S. – Admiral Byrd Chapter 11
Washington Philatelic Society

NAPEX

NATIONAL PHILATELIC EXHIBITIONS of WASHINGTON, D. C. Inc.

Dear Visitors:

On behalf of the directors, officers, and members of NAPEX, I extend a most cordial welcome to our philatelic friends, and wish you an enjoyable visit in our Nation's Capital.

We extend special philatelic greetings to officers and members of the Bureau Issues Association, the International Society for Japanese Philately, the Associated Stamp Clubs of the Chesapeake Area, the China Stamp Society, the Korea Stamp Society, George Washington Masonic Stamp Club, Robert C. Graebner Chapter of the AFDCS, Lions International Stamp Club, The Scandinavian Collectors Club, Turkey and Ottoman Philatelic Society, Americana Unit ATA, SPA, and Washington Philatelic Society, who have scheduled meetings at NAPEX.

You are cordially invited to attend the NAPEX Auctions on Friday and Saturday afternoons in the Commonwealth No. 1 Room. The auctions are handled by John W. Kaufmann, Inc., of Washington, D.C.

The show cancellation depicts 'Old Glory' – long may it wave!

Philatelically yours,
John N. Hoffman
Chairman

NAPEX, P.O. Box 61, Ben Franklin Station, Washington, D.C. 20044

NAPEX COMMITTEES

General Chairman John N. Hoffman
Vice Chairman Milton Mitchell
Finance Gerhard S. Wolff
Society Coordinator Marion Mitchell
Entries Clarence A. Stillions
Awards John N. Hoffman
Judges Milton Mitchell
Floor Manager Gary F. Paiste
Security Ralph I. Sigler
Banquet Ethel B. Williams
Publicity James H. Bruns

JUDGES

W. Eugene Tinsley, Los Angeles, Calif.
Henry Gobie, Cypress Gardens, Florida
Fred Barovick, River Edge, N.J.
Philip Ireland, Bethesda, Maryland

APPRENTICE JUDGES

Raymond W. Ruthrauff, Sr., Darby, Pa.
W. Danforth Walker, Arlington, Va.

A W A R D S

NAPEX AWARDS

NAPEX GRAND AWARD and NAPEX RESERVE GRAND AWARD

Gold, Silver, and Bronze medals will be awarded on an "Open Show" basis, without regard to classification or the various society awards.

SOCIETY AWARDS

American Philatelic Society

Medal to the best exhibit by an APS member

American Topical Association

Americana Unit ATA/APS: Armetale Tray to the best Americana exhibit

India Study Circle

Award Plaque

Korea Stamp Society

Best Korean exhibit

Society of Philatelic Americans

SPA Research Award

United Postal Stationery Society

Award Certificates

United States Cancellation Club

Certificate and Plaque

PROGRAM

2 - 4 July 1982

FRIDAY, 2 July 1982

- 10:00 AM - Exhibition and Bourse Open.
- 1:00 PM - BIA Lecture: Presidential Classroom
"ABCs of EFOs" by John M. Hotchner
- 1:30 PM - NAPEX Auction, 1st Session Commonwealth No. 1
- 3:00 PM - Turkey and Ottoman Presidential Classroom
Philatelic Society Lecture
- 4:00 PM - Americana Unit ATA Lecture Presidential Classroom
- 4:00 PM - Confederate Stamp Alliance Board Room
Slide Show
- 7:00 PM - Exhibition and Bourse Close
- 7:00 PM - Americana Unit Dinner Meeting

SATURDAY, 3 July 1982

- 10:00 AM - Exhibition and Bourse Open
- 10:30 AM - AFDCS Graebner Chapter Presidential Classroom
Lecture
- 11:00 AM - Bureau Issues Association Board Room
"Production of USPS Handstamped Cancellations"
by Melvin Gusdorf
- 12 Noon - Scandinavian Collectors Club Luncheon
- 1:00 PM - S.P.A. Lecture Board Room
"King Edward VIII", by R. W. Ruthrauff

- 1:30 PM - NAPEX Auction, 2nd Session Commonwealth No. 1
- 2:00 PM - China Stamp Society Lecture Board Room
- 2:30 PM - George Washington Masonic Presidential Classroom
Stamp Club Lecture
- 3:00 PM - Confederate Stamp Alliance Lecture Board Room
"Confederate Army Mail Markings"
by Steve Jivonski
- 4:00 PM - Interntl. Soc. for Japanese Philately Board Room
Seminar
- 4:00 PM - U.S. Philatelic Classics Soc. Presidential Classroom
Seminar: "Carrier Service to 1836"
by John D. Kohlhepp
- 6:00 PM - Exhibition and Bourse Close
- 6:30 PM - NAPEX Dutch Treat Party Commonwealth No. 1 and 2
- 7:00 PM - NAPEX Awards Banquet Commonwealth No. 1 and 2

SUNDAY, 4 July 1982

- 10:00 AM - Exhibition and Bourse Open
- 11:00 AM - Judges Critique Presidential Classroom
- 1:00 PM - Washington Philatelic Society Presidential Classroom
"D.C. Trolley Lines", by Tom Stanton
- 1:30 PM - Lions Interntl. Stamp Club Lecture Board Room
- 2:00 PM - Associated Stamp Clubs of Presidential Classroom
the Chesapeake Area, Meeting
- 2:30 PM - Korea Stamp Society Lecture Board Room
- 4:00 PM - Exhibition and Bourse Close

OF SPECIAL INTEREST

UNITED STATES POSTAL SERVICE

The U.S. Postal Service will provide a special post office station for NAPEX with a supply of commemorative stamps and a special show cancellation — "NAPEX STA." This station will be open during the hours of the show on all three days, and is located in the rear of the Chesapeake Room.

UNITED NATIONS SALES AGENCY

The United Nations Postal Administration will have a booth for sale of recent postal items and stamps. They will be available during the hours of the show in the Chesapeake Room.

WASHINGTON PLATE PRINTERS UNION

Members of the Union at the Bureau of Engraving and Printing will exhibit a display of hand-engraved and intaglio printed items. A small hand "Spider" press will be shown. A 1981 souvenir card produced by Bureau craftsmen press will be shown. The NAPEX-82 Souvenir Card will be on sale.

NAPEX MEMBERSHIP

Effective January 1982, annual NAPEX dues were established at \$2.00. Membership — as individual or club — is available at the NAPEX Office, or contact any NAPEX officer or director.

WHILE IN WASHINGTON

STAMPS and POSTAL HISTORY at the SMITHSONIAN

The national philatelic collection contains more than 14 million specimens representing every conceivable aspect of philately and postal history, including three-dimensional objects used in the mail service, many specialized collections, and stamps of all nations. This great collection is put to use in many ways, the most visible being the public exhibition in the **Hall of Stamps and the Mails**. You are cordially invited to study the thousands of philatelic items on display there, as well as the Smithsonian exhibit panels at NAPEX.

Smithsonian Institution's **Hall of Stamps and the Mails** (located on the third floor of the National Museum of American History, 14th Street and Constitution Avenue, N.W.) is open to visitors every day from 10:00 AM to 5:30 PM, and there is no admission fee.

Plan now to attend the next NAPEX show:

1 - 3 July 1983

EXHIBITS

GRAND BALLROOM: Frames 1 - 120

Frame Nos.

- 1-5 **United States Proofs**
A selection of 18th Century die and plate proofs showing shades and multiples, experimental proofs, etc.
- 6-7 **White Plains: The First U.S. Souvenir Sheet**
A collection of the varieties of the US's first souvenir sheet, and examples of various ways this "souvenir" was used to carry mail.
Stephen J. Rod
- 8-12 **The War Years, 1861-1864**
Tennessee Confederate postal history.
Buck Boshwit
- 13-18 **Georgia Confederates**
Confederate covers to and from Georgia covering various usages during this period.
McCary Ballard
- 19-20 **French Colonies: Used Postal Stationery**
All types and most colonies commercially used.
Robert G. Stone
- 21-25 **The Shield**
A study of the stamp as an example of the variety of early Bureau issues.
Don Berman
- 26-32 **Switzerland: Used Federal Stamps 1850-1881**
Color varieties, postmarks, and unusual usage.
Harlan F. Stone
- 33-40 **Haiti - The Issues of 1887-1898**
A specialized collection of essays, proofs, varieties, cancellations, and covers showing rates of the period.
Carroll L. Lloyd
- 41-46 **Zeppelin Mail: The Europa-Pan-American Flight of 1930**
Flown dispatches and their stamps.
Gerhard S. Wolff

- 47-52 **Issues of the Japanese Military Command on the Stamps of Dutch East Indies during World War II**
Overprints and regular postal issues by the Japanese military forces during their occupation of the Dutch East Indies 1942 to 1945.
Thomas R. Bleeker
- 53-60 **German Post in China during the Boxer Rebellion**
A study of the cancels relating to German postal activity in China during the Boxer Rebellion and occupation 1900 to 1906.
Diane D. Boehret
- 61-64 **Occupied Denmark**
Traces the 9 April 1940 German invasion of Denmark and its consequences, including the occupation of Danish territory by the Allied Armed Forces.
Robert Dunn
- 65-69 **Persia 1870-1925**
A survey of stamps, covers, overprints, stationery, reprints, and philatelic forgeries.
Gordon H. Torrey
- 70-74 **19th Century Post Offices of Cape May County, N.J.**
Some examples of postal markings from Cape May County post offices in existence in the 19th Century.
Craig C. Mathewson
- 75-80 **U.S. Regular Issue: The 2-Cent Shield of 1903**
A study of one regular issue postage stamp. Includes perforate, imperforate, booklet panes, shade varieties, errors, use in possessions, etc., on and off cover.
George N. Wendt
- 81-87 **United States Airmail: Rates and Flights to 1936**
Airmail covers depicting U.S. airmail rates and flights (domestic and foreign) from the pioneer period through the first return flight from the U.S. of the Hindenburg (LZ 129).
Allen D. Jones
- 88-91 **Eastern Roumelia and South Bulgaria**
Stamps, covers, specimens, forgeries.
Gordon H. Torrey
- 92-100 **German Southwest Africa**
Forerunners, stamps, postal stationery, and cancellations.
R. C. Maurer

- 101-106 **Great Britain: Surface Printed Issues, 1855-1883**
Examples and some usage of issued plates on values through 1 Lb.
Richard A. Colberg
- 107-109 **S. Korea: Korean War - U.N. Flags Commemorative Issue**
This specialized exhibit describes the large set (22 pairs) of flag stamps issued in 1951-1952. Major portions pertain to redrawn designs, EFOs, and postmarks.
C. G. Marx
- 110-115 **Austria: 19th Century Adhesive Documentary Revenues**
A showing of all the major varieties of Austrian documentary adhesives of the 19th Century with selected examples of usage.
James R. Simon
- 116-118 **Franco-Russian Alliance, 1890-1914**
The philatelic aspects.
Gordon H. Torrey
- 119-120 **The Provisionals of Newfoundland**
(Not for competition)
- CHESAPEAKE ROOM: Frames 121 -196**
- 121-123 **Arts and Artists**
A recognition of art and artists on selected U.S. postage stamps.
Brett L. Miller
- 124-128 **First Issues of the World 1840-1889**
Examples of the first stamps released by each country in the world during the first 50 years of the use of adhesive stamps.
H. H. Wineburgh
- 129-133 **The Citizens of Europe**
Persons who, in a variety of ways, contributed to the concept of a United Europe.
Stephen Luster
- 134-136 **Clara Maass, She Gave Her Life**
The story of yellow fever, the brave nurse, who put her life on the line, and efforts resulting in Cuban and U.S. commemorative issues.
Robert B. Spooner

ASSOCIATED STAMP CLUBS OF THE CHESAPEAKE AREA

- 137-143 **Philately and Murder**
Stamps, postal history, and some production phases, reveal murderers and murder victims.
 Charles M. Fitz
- 144-148 **Chess Olympiads and Chess Personalities**
Honoring the team championships played every 2 years and stamps honoring outstanding men who have made the game what it is now.
 Dorothy L. Parkhurst
- 149-152 **Black Heritage**
Martin Luther King stamps in blocks of 4 with plate #s and covers.
 James A. Guy
- 153-157 **Tokens of Affection**
The history of antique valentines from a philatelic viewpoint.
 Patricia A. Kaufmann
- 158-161 **The American Press**
Presents the story of the American press as shown by U.S. FDCs and postal cards.
 William L. Struckman
- 162-167 **The Life of Charles V (1500-1558)**
A worldwide collection of stamps, covers, and philatelic materials.
 Dorothy G. Kapenstein
- 168 **Masonic First Day Covers**
 George Washington Masonic Stamp Club
 (Not for competition)
- 169-172 **Stamps of Note**
Musical themes, such as national anthems, noted composers, and famous musicians shown on music-related philatelic items.
 Smithsonian Institution, National Philatelic Collections
- 173-174 **In a Spin over Skating**
An exhibit by a junior of movements in ice skating and ice dancing as illustrated on stamps and covers.
 Melinda Ellen Wilson
- 175-184 **A Century of Progress International Exposition,
 Chicago - 1933**
A philatelic collection of covers and cards.
 Henry M. Kapenstein

- 185-186 Korea Stamp Society, Washington, D.C. Area Chapter
- 187-188 Washington Philatelic Society
- 189-190 Washington Chapter of the China Stamp Society
- 191-192 Collectors Club of Washington, D.C.
- 193-194 Liberian Philatelic Society, Washington, D.C. Chapter
- 195-196 International Society for Japanese Philately

INDEX TO EXHIBITORS

- | | | | |
|---------------------------------|---------|-------------------------------|--------------------------|
| Ballard, McCary | 13-18 | Luster, Stephen | 129-133 |
| Berman, Don | 21-25 | Marx, C. G. | 107-109 |
| Bleeker, Thomas R. | 47-52 | Mathewson, Craig C. | 70-74 |
| Boehret, Diane | 53-60 | Maurer, R. C. | 92-100 |
| Boshwit, Buck | 8-12 | Miller, Brett L. | 121-123 |
| China Stamp Society | 189-190 | Parkhurst, Dorothy L. | 144-148 |
| Colberg, Richard A. | 101-106 | Rod, Stephen J. | 6-7 |
| Collectors Club, Washington | 191-192 | Simon, James R. | 110-115 |
| Dunn, Robert | 61-64 | Smithsonian Institution . . . | 169-172 |
| Fitz, Charles M. | 137-143 | Spooner, Robert B. | 134-136 |
| Geo. Wash. Masonic Stamp Club | 168 | Stone, Harlan F. | 26-32 |
| Guy, James A. | 149-152 | Stone, Robert G. | 19-20 |
| Int. Soc. for Japanese Phil. | 195-196 | Struckman, William L. | 158-161 |
| Jones, Allen D. | 81-87 | Torrey, Gordon H. | 65-69,
88-91, 116-118 |
| Kapenstein, Dorothy G. | 162-167 | Washington Phil. Society . . | 187-188 |
| Kapenstein, Henry M. | 175-184 | Wendt, George N. | 75-80 |
| Kaufmann, Patricia A. | 153-157 | Wilson, Melinda Ellen | 173-174 |
| Korea Stamp Society | 185-186 | Wineburgh, H. H. | 124-128 |
| Liberian Philatelic Society . . | 193-194 | Wolff, Gerhard S. | 41-46 |
| Lloyd, Carroll L. | 33-40 | | |

DEALERS BOURSE IN GRAND BALL ROOM

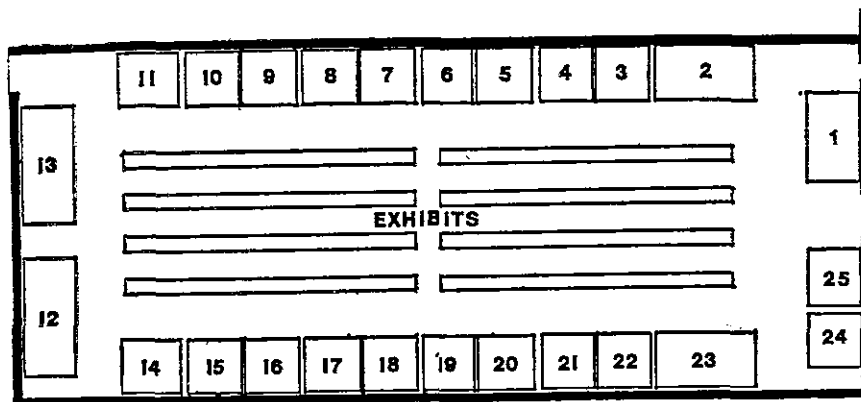

1. JOHN W. KAUFMANN, Inc., Washington, D.C.
2. METRO STAMP COMPANY, Middle Village, N.Y.
3. AMERICAN EASTERN STAMP CO., Baltimore, Md.
4. MARYLAND STAMP & COINS, Bethesda, Md.
- 5-6. MICHAEL LIFRIERI, Wildwood Crest, N.J.
- 7-8. SCOTT MICHAEL, Randallstown, Md.
9. BAILEY'S STAMP & APPRAISAL SERVICE, Cincinnati, Ohio
10. ACORN STAMP COMPANY, Tuckahoe, N.Y.
11. WESLEY A. CROZIER, Fair Haven, N.J.
12. SHULL SERVICE, Crofton, Md.
13. JOY COVERS, District Heights, Md.
14. McLEAN STAMP COMPANY, McLean, Va.
15. ABBOTT LUTZ, Inc., New York, N.Y.
16. HOFFERS COVERS & STATIONERY, Inc., Cornwall, N.Y.
17. JACK J. PERRIN, Marlton, N.J.
18. STAMP MART, Inc., Baltimore, Md.
19. NEWTON TRADING COMPANY, Plaistow, N.H.
20. HAROLD BURTON, Eagleville, Pa.
21. MOUNTAINSIDE STAMPS, Mountainside, N.J.
22. EAGLE STAMP CO., Baltimore, Md.
23. B & C STAMP COMPANY, Somerville, N.J.
24. BARRY NEWTON, Akron, Ohio
25. AALLSTAMPS, Milltown, N.J.

DEALERS BOURSE IN CHESAPEAKE ROOM

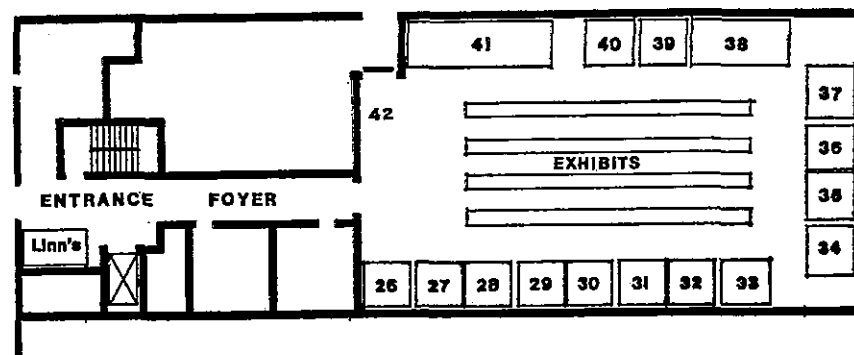

26. LANCE D. LIMOGES, Inc., State College, Pa.
27. J & D STAMPS, Inc., Cincinnati, Ohio
28. RICHARD G. TAYLOR, Mansfield, Ohio
29. KENWOOD STAMPS, Glen Echo, Md.
30. K & Y STAMPS, Bryn Mawr, Pa.
31. R. G. BOWER ASSO., Bound Brook, N.J.
32. HARRY HAINES, Jr., Monmouth, Maine
33. SCOJO STAMPS, Ridgely, Md.
34. ANDREW LEVITT, Inc., Danbury, Conn.
35. BONANZA STAMP & COIN, Silver Spring, Md.
36. B & K STAMPS, Bowie, Md.
37. OLD DOMINION STAMP SALES, Vienna, Va.
38. UNITED STATES POSTAL SERVICE
39. BUCKLIN PHILATELIC PURVEYORS, Ipswich, Mass.
40. WASHINGTON PLATE PRINTERS UNION
- 41a. ROCKVILLE STAMP & COIN, Rockville, Md.
- 41b. THE GALA STAMP ORGANIZATION, Richmond, Va.
42. UNITED NATIONS POSTAL ADMINISTRATION

NOTES



Put me to work for you.

When it's time to consign your "yesterday's collection" to auction, call me. I'll go to work for you right away. First, I'll personally come out to see you. (If I'm not in when you call, it's because I'm on the road seeing another collector. But I'll call you back.) Then, in the comfort and privacy of your home or office we can discuss the best way to handle your collection. You'll find me helpful and sympathetic.



As soon as your material is in my shop, I'll study it to determine the best way to realize the most for you. Important decisions will be weighed. Shall we clear it all out in a single auction? Shall we place parts of it in our auctions of specialized material where they would fit in nicely? Shall we place parts into sales of

"name" collections where they might be enhanced by such proximity? Shall we put aside exceptional items for inclusion in our annual Gem Sale where realizations are often astonishing? You won't be left out of these deliberations. You'll get my recommendations and reasons why before we lock up the sales.

After that, we'll turn to the critical business of lotting and describing. We pride ourselves on this. Since we know our collector-buyers, we break lots down with their interests in mind. We don't cherry-pick the easy ones and relegate the rest to large lots and remainders. We milk each decent item. This means better realizations for the collector-seller. In each lot, we look for the "hidden value" — the unusual cancel, the faint double transfer, the out-of-the-ordinary usage that would make that item a prized addition to a collection. And this too makes for better realizations for you.

We're meticulous in our descriptions. For instance, when is "fine" not so fine? A stamp off-center top and bottom is worth more than the same item off-center left

and right. Yet each can properly be described as "fine." To make sure the better "fine" gets the better price, we photo it. Who benefits? Both you and the buyer.



I work for you in other ways:

All auction catalogs are not created equal. I honestly think mine are better. Since "presentation" in a catalog is so important, you'll see that I picture 75% of the items, many larger than actual size. This 75% compares with an average of 50% in most others' catalogs. That's important for your material, because most buyers can't come personally to view the lots. If a buyer can't see what he's buying, chances are he won't buy. But a photo does the trick. Also, you'll find the important items illustrated in full color in every sale. This draws attention to them and they realize more. And as much as possible, we position photos adjacent to their lot description. That's a convenience to the buyer and a giant headache to us. But since buyers expect it and sellers request it, we do it.

A truism: "If you're willing to sell, they're willing to buy." I make sure your material is offered in my catalogs to thousands of collector specialists and dealers here and abroad. Their collecting interests cover a broad spectrum. They're a very receptive audience for quality material and they're serious buyers.

As an auction is concluded and the hammer falls on the last lot, we'll already be hastening our settlement with you to get your money into your hands. A number of factors will be working for you here. First, our computerized system eliminates the mountain of tedious paper work in tracking and invoicing every lot and bidder. Secondly, our buyers tend to pay promptly; we discourage slow payers by dropping them from the catalog list. Most important, our return rate is surprisingly low. We work hard at that by making sure our descriptions are accurate, our claims not exaggerated, and most material photographed.

Let me respectfully suggest that when the time comes to sell, take a few minutes for a toll-free call to me (800-424-9519). Let's discuss your collection. You may end up putting me to work for you then and there.



John W. Kaufmann

John W. Kaufmann, Inc.
1522 K Street, N.W.
Washington, D.C. 20005

CALL TOLL FREE: 800-424-9519
IN WASHINGTON, D.C. AREA,
CALL: (202) 638-5658



37 111NC BR
04/93 198115

4835